

Universal Gauge Quick Install Guide for Haltech ECU

Thank you for your order!

The customer satisfaction at Perfect Tuning is our biggest priority. If you have any questions, suggestions or issues do not hesitate to contact us at support@perfecttuning.net or on Facebook.

User manual and latest firmware version is available on the product page at

<http://perfecttuning.net>

Package includes:

- Perfect Tuning Universal Gauge
- 5 ft. cable
- Mounting bracket with 2x 4-40 screws

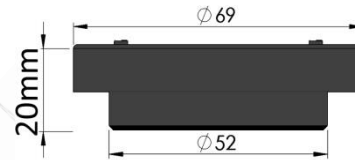

WARNING

Do not use longer screws than provided in the two rear mounting holes. Using too long screws can touch the circuit board inside and damage the gauge.

Opening the gauge will void the warranty.

Wiring

Always disconnect the vehicle battery when installing the gauge. Do not leave any wires not isolated. Always solder or crimp the wires and protect with heat shrink. Refer to the user manual to connect the sensors.

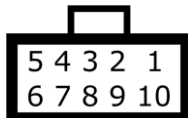

View when looking at the gauge.

Pin	Color	Function
1	Red	12v (+). Always install the gauge on a fused supply (3A)
2	Black	Vehicle Ground (-)
3	White	0-5v analog input 1 (optional)
4	Yellow	0-5v analog input 2 (optional)
5	Brown	CAN H
6	Purple	CAN L
7	Orange	0-5v analog input 3 (optional)
8	Gray	Digital input (not available)
9	Blue	5v output (optional)
10	Green	Digital output. Connected to the ground when output is enabled.

Connection to the Haltech ECU

No configuration needed. Not all CAN Packets will always be broadcast. The Haltech ECU may opt not to broadcast a particular packet if that feature is not enabled.

The Haltech Platinum series has an 8 pin CAN bus plug. The Perfect Tuning Universal Gauge can come with the plug so the installation is plug and play. Here is the pinout for reference.



Pin #	Function
1	Ground
2	120 Ohm Terminating Resistor Loop
3	CAN LO
4	12V Out
5	Reserved
6	120 Ohm Terminating Resistor Loop
7	CAN HI
8	Reserved

On the Haltech 550 and 750, the CAN pins are on the main 34P connector (CANH = pin 16, CANL = pin 17)

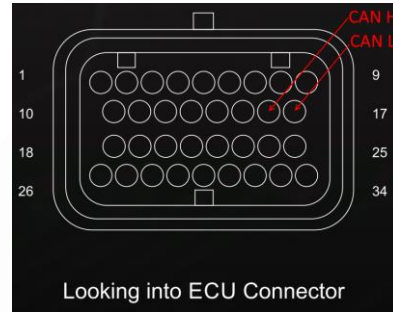

The Haltech Elite ECU's 1000 and over have the CAN bus available at 2 different locations. On the main 26P connector (CANH = pin 23, CANL = pin 24) and also on the Aux CAN Port. You can use either location.

CAN Aux Port

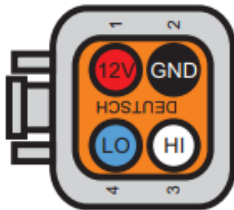

Pin 1 - 12V
 Pin 2 - Ground
 Pin 3 - CAN High
 Pin 4 - CAN Low

Main 26P Connector (B)

